



TAI-SAW TECHNOLOGY CO., LTD.

No. 3, Industrial 2nd Rd., Ping-Chen Industrial District,
Taoyuan, 324, Taiwan, R.O.C.

TEL: 886-3-4690038 FAX: 886-3-4697532

E-mail: tstsales@mail.taisaw.com Web: www.taisaw.com

Approval Sheet For Product Specification

Issued Date:

Product Name: SAW IF Filter 374MHz

TST Parts No.: TB0151A

Customer Parts No.: _____

Company: _____
Division: _____
Approved by : _____
Date: _____

Checked by: _____ Andy Lee

Approval by: _____ Francis Chen

Date: _____ 9,30 ,2004



TAI-SAW TECHNOLOGY CO., LTD.

No.3, Industrial 2nd Rd., Ping-Chen Industrial District, Taoyuan, Taiwan, R.O.C.
TEL: 886-3-4690038 FAX: 886-3-4697532
E-mail: tstsales@mail.taisaw.com

SAW Filter 374MHz

MODEL NO.: TB0151A

REV. NO.:3

A. MAXIMUM RATING:

1. Input Power Level: 10 dBm
2. Operating Temperature: -10°C to 85°C
3. Storage Temperature: -40°C to 85°C

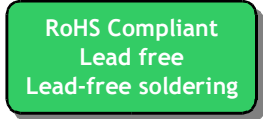

B. ELECTRICAL CHARACTERISTICS:

Item	Unit	Min.	Type.	Max.
Center frequency, Fc	MHz	-	374	-
Insertion Loss, IL (From Min IL)	dB	-	7.5	9
Passband width, BW3	MHz	14	15	-
Amplitude Ripple in $Fc \pm 4\text{MHz}$	dB	-	0.5	1
Group delay ripple in $Fc \pm 4\text{MHz}$	nS	-	57	100
Attenuation:(Reference level from Min IL)				
Rejection: 279-346MHz	dB	40	49	-
Rejection: 346-357MHz	dB	40	46	-
Rejection: 357-360.5MHz	dB	35	43	-
Rejection: 387.5-391MHz	dB	25	38	-
Rejection: 391-425MHz	dB	30	44	-
Rejection: 425-469MHz	dB	40	46	-

C. FREQUENCY CHARACTERISTICS:

(1) wide band of Response:

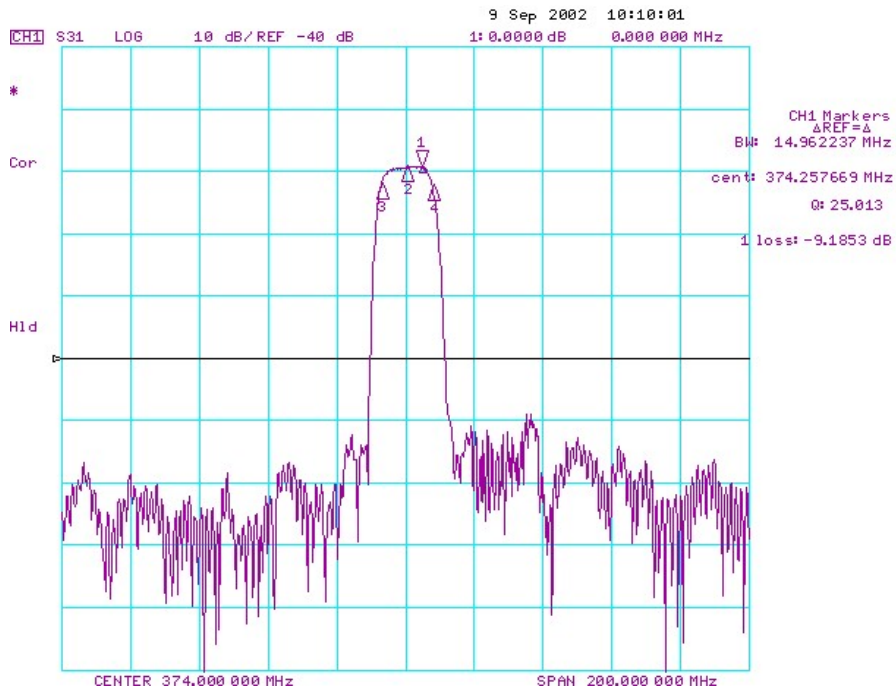

Fig-1 S21 Response Horizontal: 20MHz/Div
Vertical: 10dB/Div REF. : -40dB

(2) Group Delay and Ripple

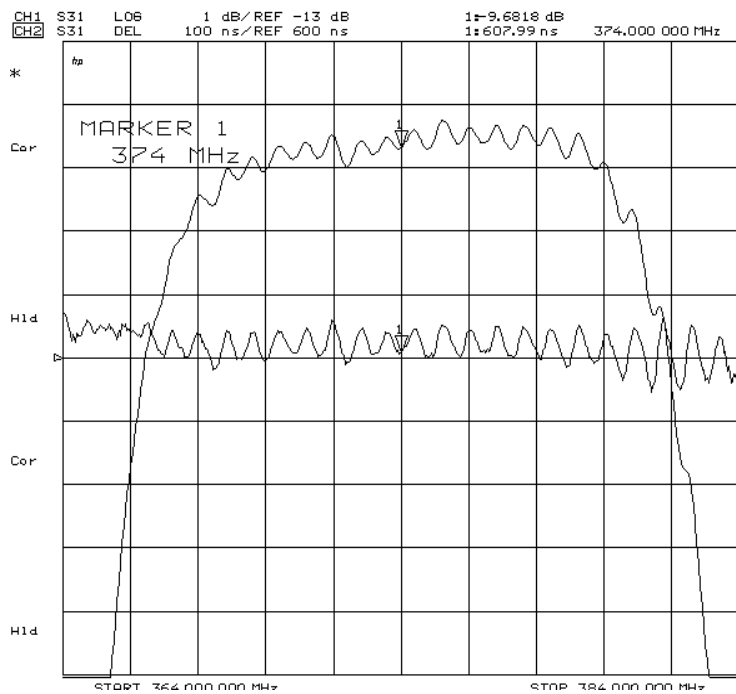
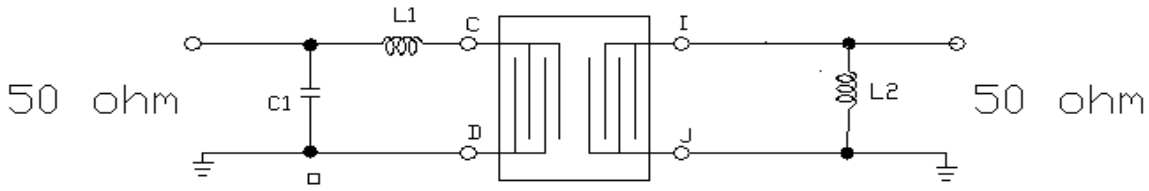

Fig-3 S21 Response Horizontal: 3 MHz/Div Vertical: 1dB/Div, Ref: -13dB
Vertical 2: 100nS/Div, Ref: 600nS

D. MEASUREMENT CIRCUIT:

(1) 50 ohm unbalanced:



L1=8nH, L2=15nH
C1=10pF

E. OUTLINE DRAWING:

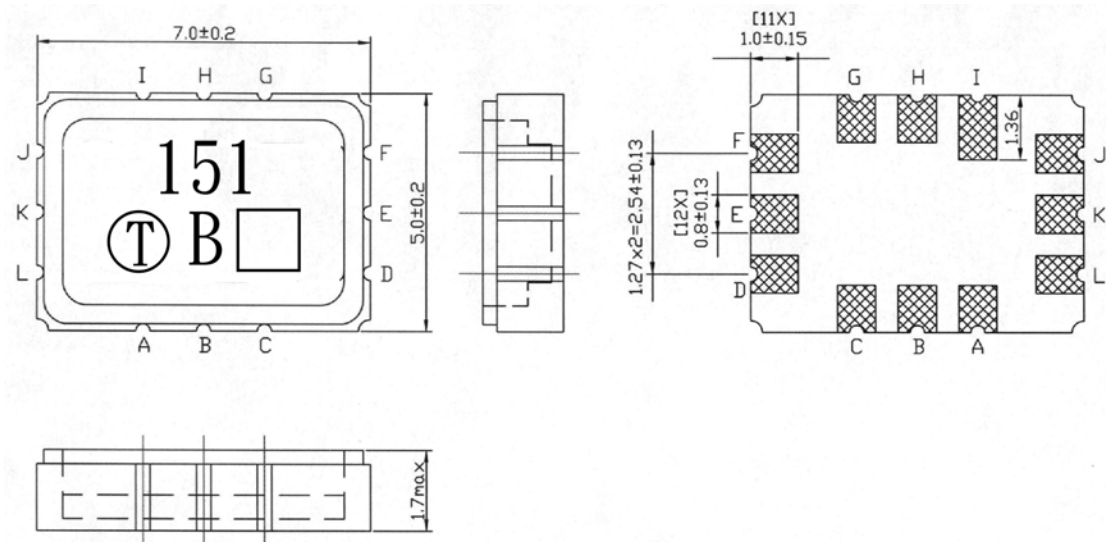

Pin C: Input

Pin D: Input Ground

Pin I : Output

Pin J: Output Ground

A,G,E,F,K,L case ground

B,H to be ground

□: Date code

Unit: mm

F. PACKING:

1. REEL DIMENSION

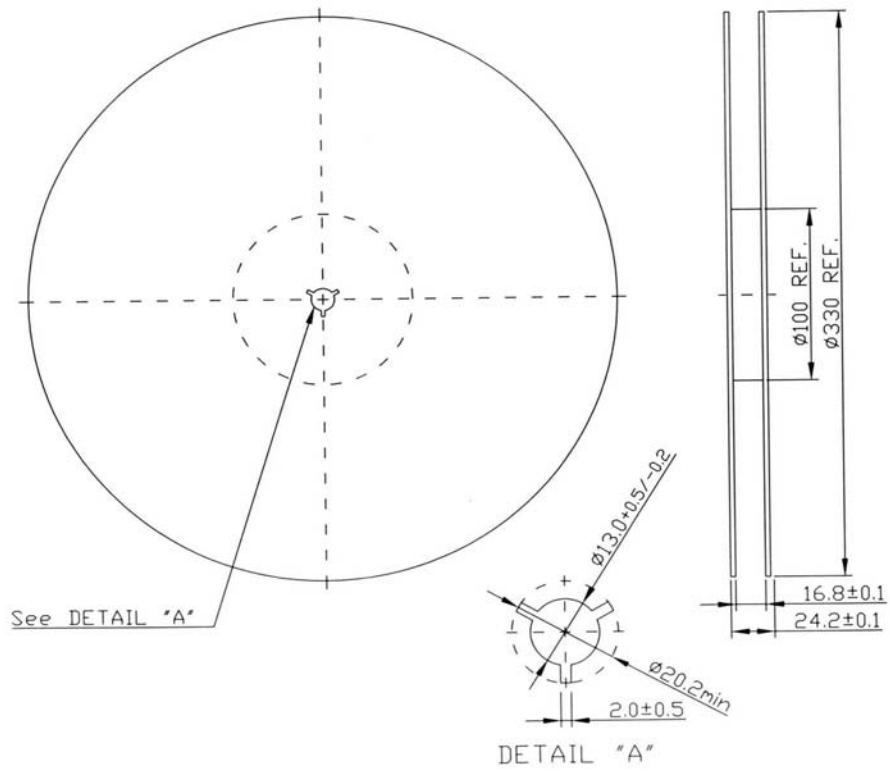

2. TAPE DIMENSION

